

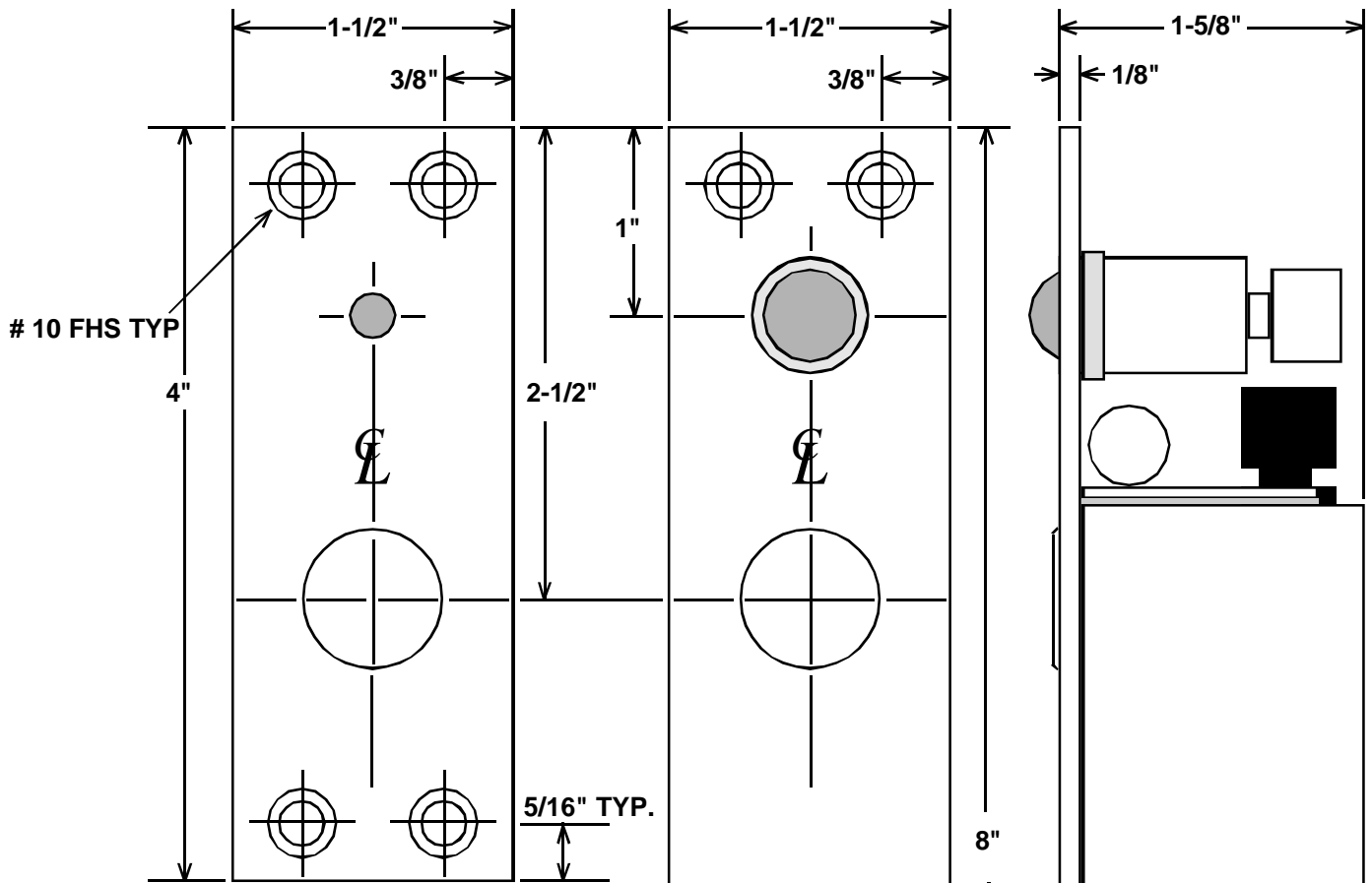

705 Emmett Street Bristol, CT 06011-2728
 Phone:(860)582-4761 Fax:(860)585-0338

MODEL #1300
MORTISE ELECTRIC DEADBOLT
INSTALLATION INSTRUCTIONS



Features

- ✘ **FAIL SAFE:** Bolt extends only when power is applied and lock is energized. Interruption of power causes the bolt to automatically spring retract.
- ✘ **NARROW 1-5/8" BACKSET:** Compact design allows for installation in header or jamb plus top, vertical or bottom door stile when power is transferred to the door.
- ✘ **STATUS MONITORING:** Optional built-in door and/or bolt position status reporting with a choice of concealed or visible sensors.
- ✘ **SILENT and CONTINUOUS DUTY:** Heavy duty low voltage solenoid is designed to withstand continuous duty.

OPTIONS CHECK OFF LIST:

- | | | | |
|---------------------------------|-------------------------------------|-------------------------------|-------------------------------|
| <input type="checkbox"/> 12 VDC | <input type="checkbox"/> 12 VAC/VDC | | |
| <input type="checkbox"/> 24 VDC | <input type="checkbox"/> 24 VAC/VDC | | |
| <input type="checkbox"/> ARSB | <input type="checkbox"/> ARSM | <input type="checkbox"/> DPSB | <input type="checkbox"/> DPSM |
| <input type="checkbox"/> BPS | <input type="checkbox"/> MB | | |

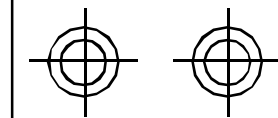

INSTALLATION:

NOTE: NOT RECOMMENDED FOR INSTALLATION IN WOOD FRAMES.

1. PROVIDE A CUTOUT WITH CLEARANCE FOR A 1-1/2" WIDE x 8" HIGH LOCK FRONT. A 1-5/8" BACKSET MINIMUM MUST BE PRESENT.
2. PROVIDE A CUTOUT WITH CLEARANCE FOR A 1-1/2" WIDE x 4" HIGH STRIKE.

NOTE: ONE EDGE OF THE LOCKFRONT AND STRIKE MUST BE IN LINE TO PROPERLY POSITION THE BOLT.

3. INSTALL MOUNTING BRACKETS AT THE ENDS OF BOTH STRIKE AND LOCKFRONT CUTOUTS.

BRACKETS SHOULD PROJECT INTO CUTOUT AREA 9/16" MAXIMUM, LEAVING A CLEAR OPENING OF 6-7/8" FOR THE LOCKFRONT AND 2-7/8" FOR THE STRIKE.

4. INSTALL LOCK AND STRIKE IN CUTOUTS AND USE THE MOUNTING HOLES IN THE LOCK FRONT AND STRIKE AS TEMPLATES TO FINISH DRILLING SCREW LOCATIONS IN THE MOUNTING BRACKETS.
5. REMOVE ANY METAL CHIPS OR BURRS LEFT BY THE INSTALLATION.
6. MAKE WIRE CONNECTIONS AND TAKE CARE NOT TO PINCH ANY WIRING WHEN INSTALLING THE LOCK.

WIRING:

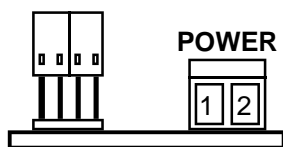

GENERAL:

THE 1300 USES A TWO POSITION TERMINAL BLOCK FOR POWER CONNECTIONS AND REMOVEABLE CONNECTORS FOR OPTION WIRING.

12 OR 24 VDC:

APPLY THE VOLTAGE AS FOLLOWS, NEGATIVE TO PIN 1 POSITIVE TO PIN 2.

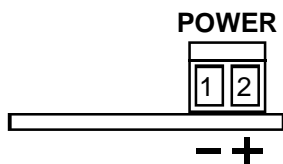

12 OR 24 VAC:

THE CONNECTIONS ARE NOT POLARIZED FOR AC OPERATION. APPLY THE VOLTAGE TO PINS 1 AND 2.

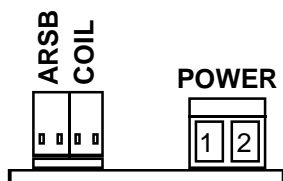
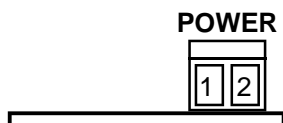

ARSB:

TO ADJUST THE BALL SWITCH, DISCONNECT THE ARSB CONNECTOR, LOOSEN THE LOCKING RING, THEN ADJUST THE SWITCH AS REQUIRED.

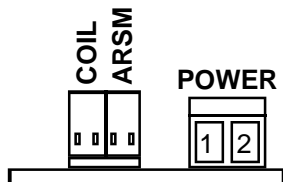

ARSM:

THERE IS NO ADJUSTMENT FOR THE ARSM.

OPTIONS:

DESCRIPTIONS:

ARSB - AUTO RELOCK SWITCH BALL TYPE, SPDT SWITCH INSURES THAT THE DEADBOLT WILL ONLY PROJECT WHEN THE DOOR IS IN THE CLOSED POSITION.

ARSM - AUTO RELOCK SWITCH MAGNETIC, SPST SWITCH SIMILAR FUNCTION TO ARSB. NOT RECOMMENDED FOR INSTALLATION IN STEEL DOORS.

BPS - BOLT POSITION SWITCH, SPDT SWITCH SIGNALS A BOLT EXTENDED OR RETRACTED CONDITION

DPSB - DOOR POSITION SWITCH BALL TYPE, SPDT SWITCH SIGNALS A DOOR CLOSED / OPEN CONDITION TO A REMOTE LOCATION.

DPSM - DOOR POSITION SWITCH MAGNETIC, SPDT SWITCH SIGNALS A DOOR CLOSED / OPEN CONDITION TO A REMOTE LOCATION. NOT RECOMMENDED FOR INSTALLATION IN STEEL DOORS.

MB - MOUNTING BRACKETS, 1 SET (4 PIECES) OF PREDRILLED MOUNTING BRACKETS TO FACILITATE LOCK MOUNTING.

WIRING:

FOR ALL OPTIONS DPSB, DPSM AND BPS THE WIRE COLORS AND FUNCTIONS ARE SHOWN BELOW,

RED	NORMALLY CLOSED
GREEN	NORMALLY OPEN
WHITE	COMMON