

EAX® EXIT ALARMS

EAX-300

Battery Powered Door Propped Alarm

The Detex EAX-300 Series is designed for applications where doors may be used for egress or ingress, but may not be held or propped open. Door open times from 1 second to 4 minutes (15 second default) are field selectable. The smaller size make installation quick and easy.

Shown with mortise cylinder
(cylinder sold separately)

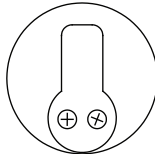

Benefits -

- Low cost, solution to propped open doors
- Helps keep energy costs down by ensuring doors are closed
- Alarm silences when door is closed, no waiting for key-holder to arrive
- Quick, easy installation saves time and money

Features -

- Secure, tamper resistant housing
- Tapered cover allows for installation on narrow stile doors, 2" minimum
- 100 dB piezo alarm
- Patented plastic template assures accurate installation by providing foolproof alignment with internal magnetic door contact
- Intelligent circuit senses the external magnet location automatically and sets the correct door handing
- 9VDC battery operated with Low Battery Alert
- LED visual arming indicators

Mechanical Options -

- EAX-300 may be ordered in several kit configurations:
 - SK1 Kit allows for wall mounting and includes (1) white MS-1039S door contact
 - SK2 Kit allows for wall mounting and includes (2) white MS-1039S door contacts
 - SK3 Kit allows for wall mounting and includes (1) brown MS-1059S door contact
 - SK4 Kit allows for wall mounting and includes (2) brown MS-1059S door contacts
 - SK5 Kit allows for wall mounting and includes (1) grey MS-2049S door contact
 - SK6 Kit allows for wall mounting and includes (2) grey MS-2049S door contacts
- KS - Key Stop, factory installed
- SI - Status Indicator On

Electrical Options -

- Weatherized for use on gates or doors that are subjected to inclement weather

Accessories -

- MC65 - Mortise Cylinder
- IC7 - 7 pin IC Cylinder Housing
- IK7 - Cylinder InstaKey Housing

Technical Information -

- Machine and self-drilling screws
- Optional Cylinder Nut Wrench
P/N: 103779



Finishes -

- GY - Grey
- BK - Black

Dimensions -

Front and Side View

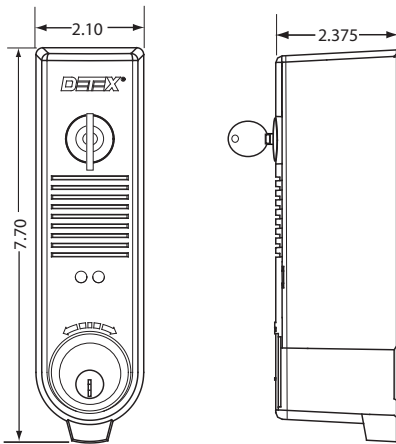

Mortise Cylinder (sold separately) - dimensions approximate

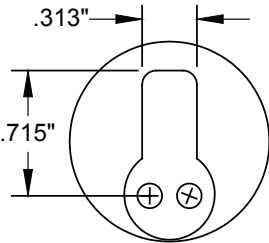

Riser Diagram

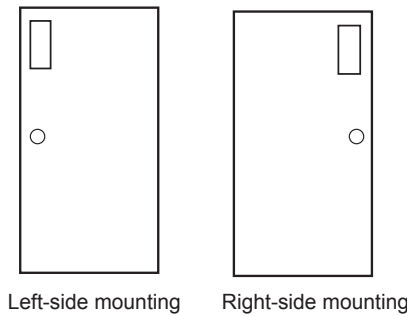

Left-side mounting

Right-side mounting

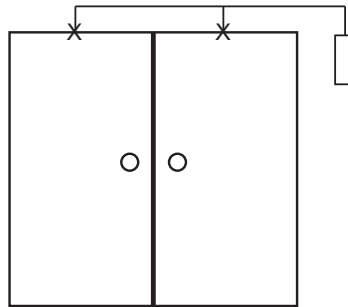

Door switch actuated

Detex Limited Warranty

3 Year Limited Manufacturer's Warranty

Listings and Approvals



"UL Listed Miscellaneous Fire Door Accessory"



ANSI/BHMA A156.29

Where Trust is Built™
DETEX®
Life Safety and Security Door Hardware

Detex Corporation
302 Detex Drive
New Braunfels, Texas 78130-3045 USA
PH. (830) 629-2900
(800) 729-3839
FAX (830) 620-6711
(800) 653-3839
<http://www.detex.com>
USA Sales:
marketing@detex.com
International Sales:
export@detex.com